



Access Control

DORMA MasterCard XS Cylinder

DORMA MasterCard XS cylinder – the multi-talent access control solution

The DORMA XS cylinder is a universally applicable, battery-operated lock actuator comprising a reader module, a europrofile cylinder adapter and a mechanical knob. The reader electronics and the mechatronic coupling system are installed together with the batteries inside the reader module. Combination of the XS cylinder reader module with a cylinder adapter

converts conventional locks prepared for europrofile cylinders into an access control system without the need for major installation work. The XS cylinder can thus be used as a cost-efficient solution for both new projects and for existing buildings. The user IDs can take the form of various transponder media such as ISO cards, fobs, watches, etc.

Technical specifications: DORMA MasterCard XS cylinder

Dimensions	
Reader module:	40 mm dia, length 41 mm
Knob:	29.5 mm dia, length 20 mm 34.0 mm dia, length 20 mm
Europrofile cylinder adapter:	25/25 mm up to 50/60 mm
Door thickness (incl. fitting):	40 to 120 mm
Power supply:	Lithium batteries type CR-2, 3V
Battery life:	approx. 25,000 operations, up to 10 years
Battery low/change indicator:	Yes
Emergency power supply:	Possible
Operating temperature:	-25 °C to 65 °C
Class of protection:	IP 67
Application locations:	Indoor and outdoor
No. of access authorisations:	max. 99
Access mode:	Non-contacting with proximity ID card or fob featuring HITAG 1 transponder

The main advantages at a glance

- Easy to install, no drilling necessary
- No chasing, cabling or wiring work
- Suitable for all europrofile cylinder locks
- Modular design for minimal investment outlay
- Easy MasterCard programming
- Secure access control with personalised ID media

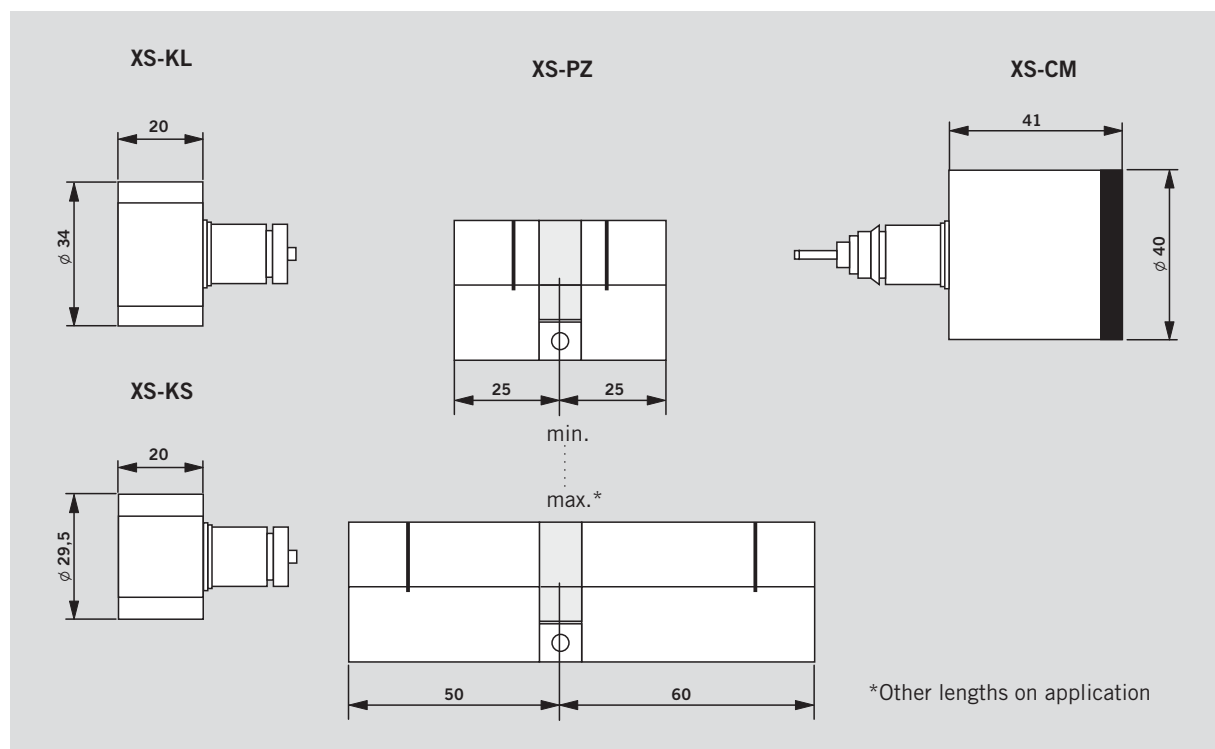

DORMA MasterCard XS cylinder – the modular construction kit

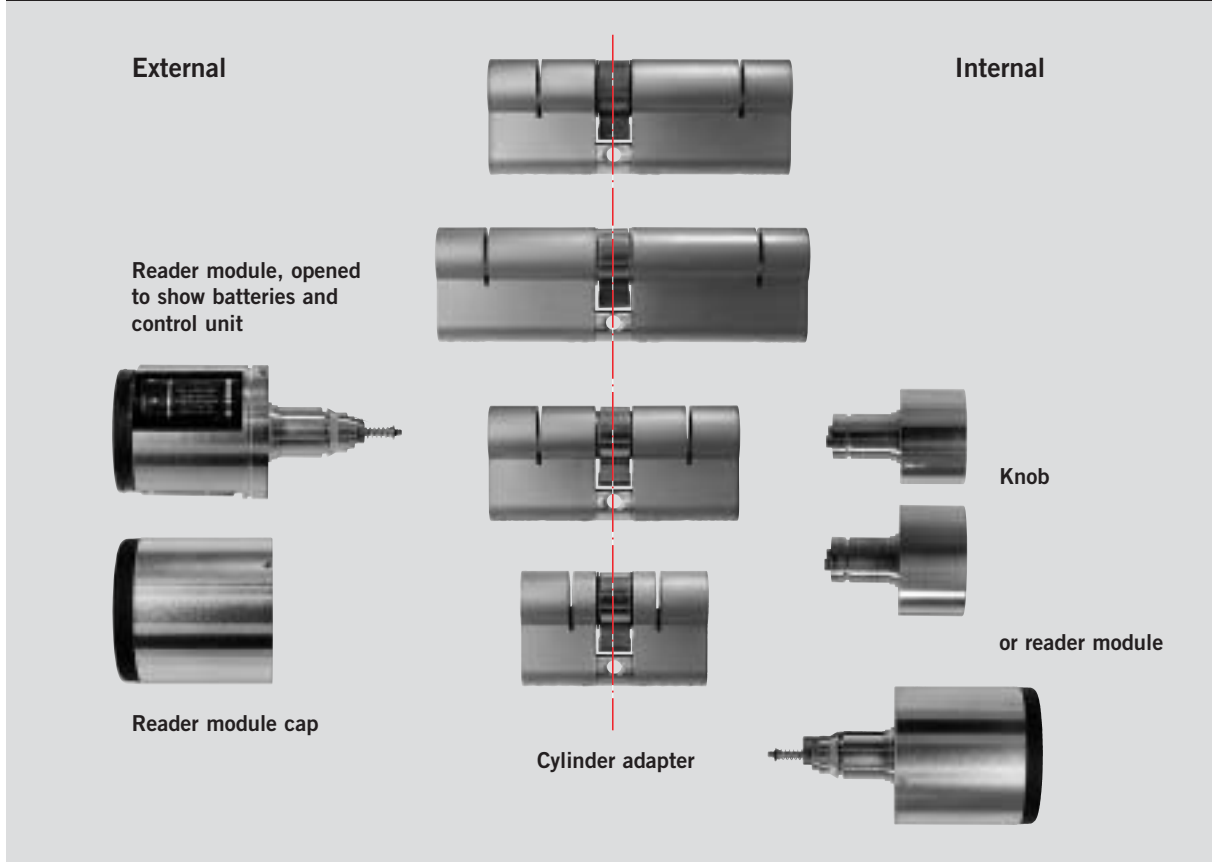

The requisite cylinder adapter dimension can be determined either by measuring the europrofile cylinder located in the door or by measuring the door and fitting thicknesses. This will provide you with lengths L1 and L2, which you can then compare with the cylinder adapter dimensions in the table.

Note:

In order to avoid presenting areas susceptible to mechanical attack, the cylinder adapter should be as flush as possible with the door fitting. We recommend that the projection on the outside of the door be no more than 2 millimetres.

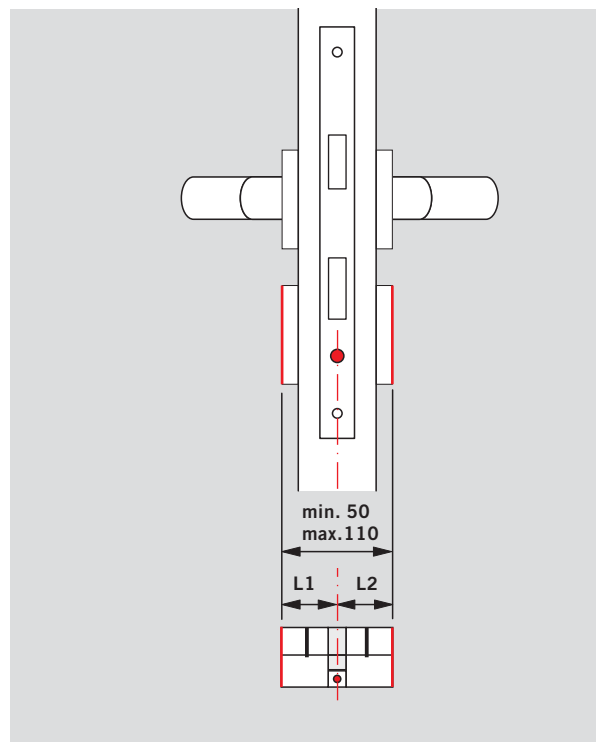

Specification text

XS-CM reader module

Reader module for XS cylinder, MasterCard model, for access control on doors. The reader module detects proximity ID cards or transponder fobs of the type HITAG 1.

Up to 99 ID cards or transponder fobs can be authorised for operation in conjunction with the electronic XS-CM reader module. Where required, authorisations can be provided with a permanent-open enable function, allowing the door to be opened in the morning and locked at night.

The XS MasterCard cylinder is designed as a learn-delete system. The ID cards or transponder fobs to be authorised can be read in directly at the door. Programming is performed by holding the programming card at the reader and presenting the ID devices at the reader module that are to be authorised or deleted. Lost ID cards or transponder fobs can also be deleted from the reader module using the programming card. All ID cards and transponder fobs are unique entities. The use of XS cylinders enables implementation of a wide range of master key concepts in line with given or changing circumstances.

For added protection against tampering/manipulation, the reader module may only be removed and the battery changed on the basis of corresponding authorisations. Operating conditions are visually and audibly signalled. The modular kit concept enables installation in a wide range of different door thicknesses and satisfaction of various access control requirements.

Finish: mock stainless steel/end face black

Dimensions: 40 mm dia., length 41 mm

In addition to the XS-CM electronic reader module, the following components will need to be ordered separately for the access side:

XS-PZxx XS cylinder adapter, XS-CBP XS battery pack, XS-Kx mechanical XS knob or additional electronic reader module for the interior.

XS-CM pack of 1

XS-CM pack of 10

Order No.

19020004

19030004  XS-CM

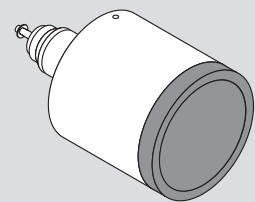

CODIC CARD ID card CCH-0x

Card with passive HITAG 1 transponder for personalised identification of authorised personnel. Each card is a unique entity. Can be used in conjunction with other systems operating with HITAG 1 technology, e.g. for individualised canteen billing.

Dimensions (W x H x T) 85 x 54 x 0.75 mm

- CCH-01** two-colour print on one face with CODIC CARD inscription
- CCH-02** blank

19175001

19175002  CCH-0x



CODIC CARD transponder fob CTH-03

Key fob with passive HITAG 1 transponder for personalised identification of authorised personnel. Each fob is a unique entity. Can be used in conjunction with other systems operating with HITAG 1 technology, e.g. for individualised canteen billing.







Typical reading distance 3 cm

Dimensions (W x H x T) 30 x 45 x 1.5 mm

19175003

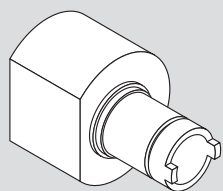
 CTH-03

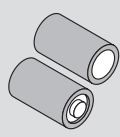

Specification text	Order No.	
<p>XS-Kx knob Mechanical knob with recessed grip for combination with XS cylinder components. Finish: mock stainless steel</p> <p>XS-Kx pack of 1 Type Diameter XS-KS 29.5 mm XS-KL 34.0 mm</p> <p>XS-Kx pack of 10 Type Diameter XS-KS 29.5 mm XS-KL 34.0 mm</p>	<p>19180104 19180204  XS-K</p> <p>19180304 19180404  XS-K</p>	
<p>XS-CBP battery pack Battery pack comprising 2 single CR2 lithium batteries for fitting to an XS reader module.</p> <p>XS-CBP pack of 2</p>	<p>19154000  XS-CBP</p>	
<p>XS-CBC battery change tool Battery change tool for easy battery change in XS reader modules.</p> <p>XS-CBC pack of 5</p>	<p>19154001  XS-CBC</p>	

Specification text

XS-PZxx cylinder adapters

Cylinder adapters for combination with XS cylinder components.

Suitable for non-directional installation in europrofile (PZ) type locks according to DIN 18254.

Modular range from 25/25 mm to 50/60 mm; other dimensions on application.

Cylinder adapter lengths will need to be specified in accordance with the details of the door concerned and the selected fittings.

XS-PZxx pack of 1

Type	Dimensions	Order No.
XS-PZ 01	25x25	19160101
XS-PZ 02	25x30	19160102
XS-PZ 03	25x35	19160103
XS-PZ 04	25x40	19160104
XS-PZ 05	25x45	19160105
XS-PZ 06	25x50	19160106
XS-PZ 07	25x55	19160107
XS-PZ 08	25x60	19160108
XS-PZ 09	30x30	19160109
XS-PZ 10	30x35	19160110
XS-PZ 11	30x40	19160111
XS-PZ 12	30x45	19160112
XS-PZ 13	30x50	19160113
XS-PZ 14	30x55	19160114
XS-PZ 15	30x60	19160115
XS-PZ 16	35x35	19160116
XS-PZ 17	35x40	19160117
XS-PZ 18	35x45	19160118
XS-PZ 19	35x50	19160119
XS-PZ 20	35x55	19160120
XS-PZ 21	35x60	19160121
XS-PZ 22	40x40	19160122
XS-PZ 23	40x45	19160123
XS-PZ 24	40x50	19160124
XS-PZ 25	40x55	19160125
XS-PZ 26	40x60	19160126
XS-PZ 27	45x45	19160127
XS-PZ 28	45x50	19160128
XS-PZ 29	45x55	19160129
XS-PZ 30	45x60	19160130
XS-PZ 31	50x50	19160131
XS-PZ 32	50x55	19160132
XS-PZ 33	50x60	19160133
XS-PZ S	Special custom lengths on application	19160139



Order No.

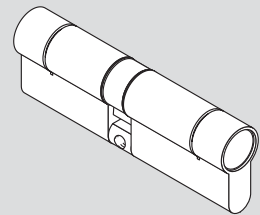
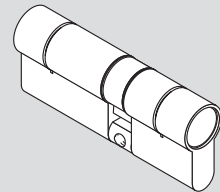
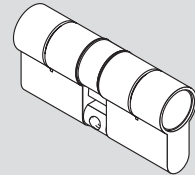

XS-PZ

**XS MasterCard cylinder –
how it works:**

The XS MasterCard cylinder is designed as a learn-delete system. The ID cards or transponder fobs to be authorised can be read in directly at the door. Three authorisation cards are required for programming, battery changing and equipment modifications. The first card to be presented to the reader module is the MasterCard, the second is the BatteryCard and the third is the ModificationsCard. In order to activate or delete the access authorisations, the programming card (XS MasterCard) needs to be held at the XS cylinder. The reader module invokes the programming mode and the ID medium can then be authorised or deleted.

The XS cylinder has two functional operating positions: engaged and disengaged. In the disengaged condition, the reader module ("electronic knob") rotates freely without operating the lock cam. Presentation of an authorised ID medium engages the cam. Now, as the reader module is rotated, the cam is operated and actuates the latch and/or bolt in accordance with the type of lock concerned. The cylinder operating status is visually and audibly signalled at the reader module.

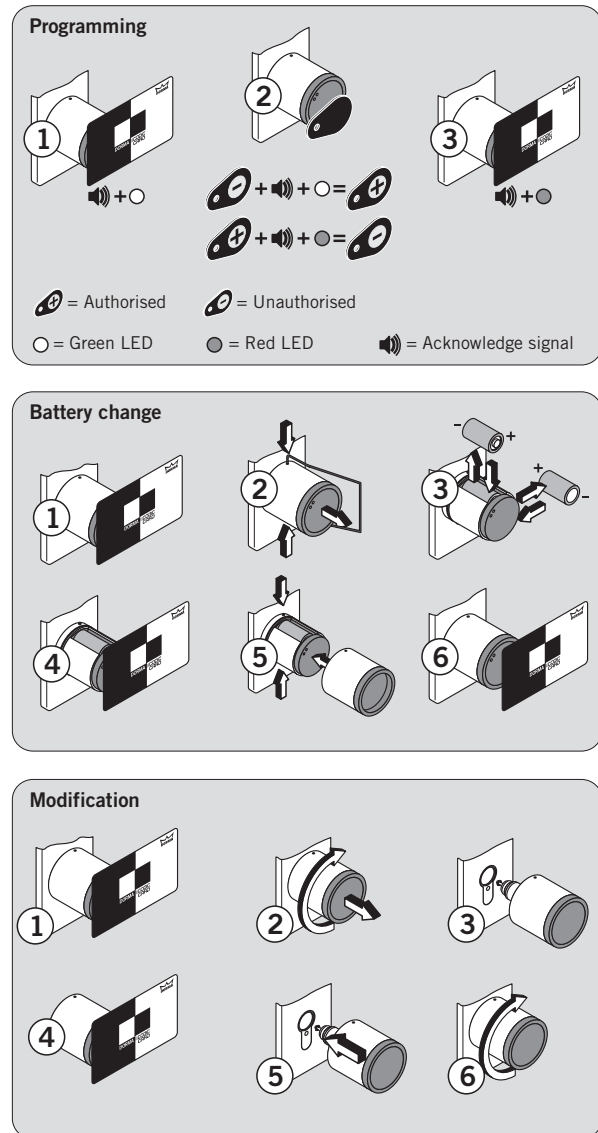

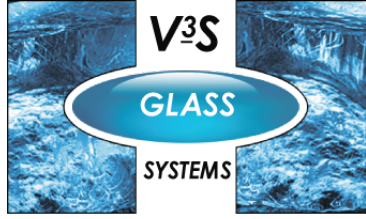

www.v3s-glass-systems.be



Door Control



Automatic



Glass
Fittings and
Accessories



Security/
Time and
Access (STA)



Movable
Walls